

**Overview**

The Strain Clamps are designed to secure conductors and ground wires with insulators or link fittings to tower arms and substation structures. It is mainly used in applications involving distribution or transmission lines. U bolts, nuts, and washers are required to fix the conductors to the body. The additional special liners or armor tape provides protection for the conductor from subsequent damages.

**Strain Clamps (Bolt Type)**

The clamp body and keepers are malleable iron, cotter-pins are stainless steel, the other parts are steel. All ferrous parts are hot-dip galvanized.

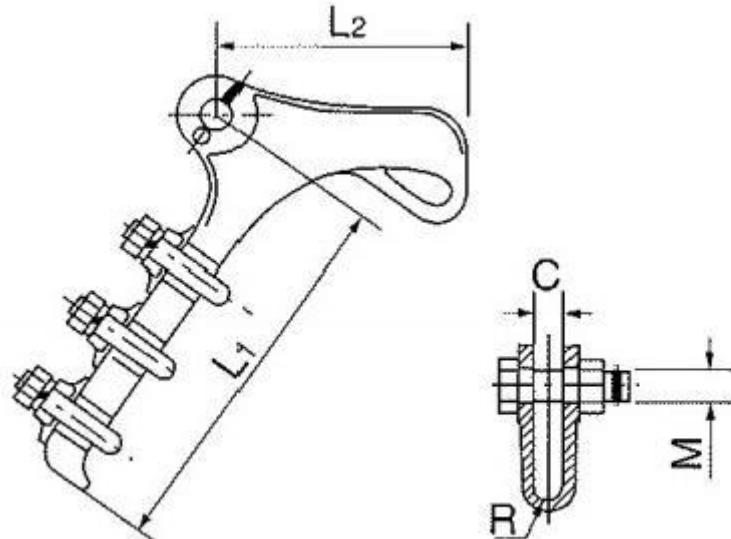

Catalog No.	Conductor Dia(mm)	Dimensions(mm)					U Bolt		Raled Failure Load(kN)	Weight(kg)
		M	C	L1	L2	R	Qty(pc.)	dia(mm)		
NLD-1	50-10.0	16	18	150	120	6.5	2	12	20	1.3
NLD-2	10.1-14.0	16	18	205	130	8	3	12	40	2.1
NLD-3	14.1-18.0	18	22	310	160	11	4	16	70	4.6
NLD-4	18.1-23.0	18	25	410	220	12.5	4	16	90	7.1

**Strain Clamps for Steel Wire (Compression Type)**

Hot-dip galvanized steel.

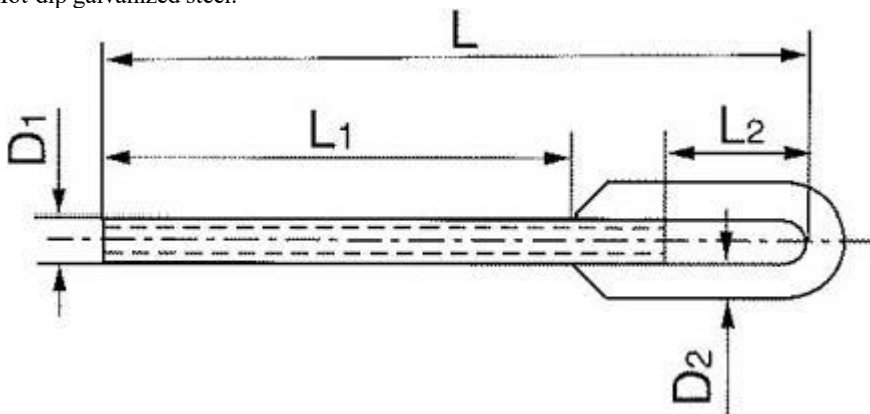

Catalog No.	Dia.of steel wire(mm)	Dimensions(mm)					Slip Strength (kN)	Weight(kg)
		D <sub>1</sub>	D <sub>2</sub>	L	L <sub>2</sub>	L		
NY-35G	7.8	16	16	115	50	205	45	0.6

NY-50G	9	18	16	130	55	230	60	0.7
NY-70G	11	22	18	155	110	315	88	1.3
NY-100G	13	26	20	185	130	365	123	1.7
NY-120G	14	28	22	195	70	320	143	2
NY-135G	15	30	22	215	80	365	164	2.3
NY-150G	16	32	24	230	90	390	187	2.8

**Strain Clamps (Hydraulic Compression Type)**

The clamp body and jumper clamp are aluminum, the other parts are hot-dip galvanized steel.

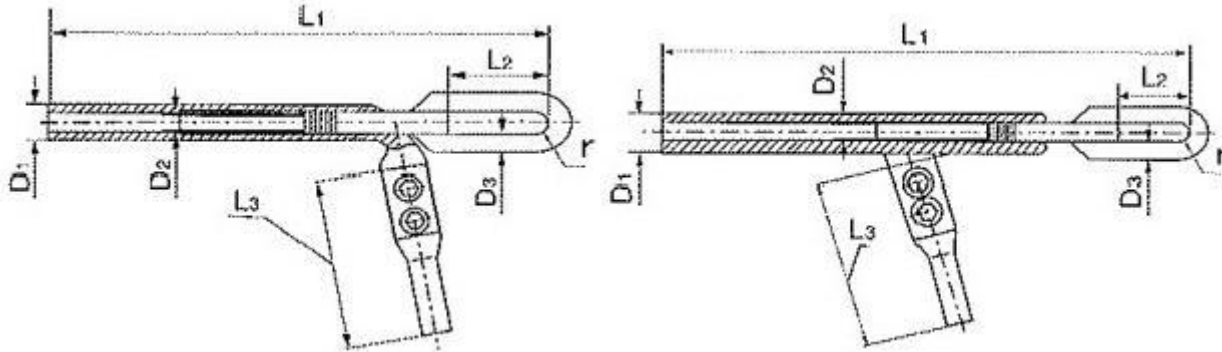

Catalog No.	Suitable Conductor	Dimensions(mm)							Slip Strength(kN)	Fig.No.	Weight(Kg)
		D	D <sub>1</sub>	D <sub>2</sub>	L	l <sub>2</sub>	l	L <sub>3</sub>			
NY-50/30	LGJ-50/30	32	16	16	330	60	8.5	180	41		1.4
NY-60/35	LGJ-60/35	32	16	16	450	60	8.5	180	46	1	1.6
NY-70/40	LGJ-70/40	32	16	16	450	50	8.5	180	55	1	1.9
NY-95/55	LGJ-95/55	34	22	18	406	50	11	210	74		2.1
NY-95/140	LGJ-95/140	45	30	24	605	80	15	245	163		4.9
NY-150/20	LGJ-150/20	30	16	16	510	55	8	285	44		3.6
NY-150/35	LGJ-150/35	32	16	16	475	55	9	210	61		2
NY-185/30	LGJ-185/30	32	16	16	460	55	9	295	62		2.2
NY-185/45	LGJ-185/45	34	18	16	495	60	10	240	76		2.6
NY-240/30	LGJ-240/30	36	16	18	500	55	10	240	72		2.5
NY-240/40	LGJ-240/40	36	16	18	515	55	10	240	79	1	2.5
NY-240/55	LGJ-240/55	36	20	18	535	55	11	250	97		2.7
NY-300/15	LGJ-300/15	40	14	16	490	50	11	265	65		2.6
NY-300/20	LGJ-300/20	40	14	18	510	55	11	265	72		2.8
NY-300/25	LGJ-300/25	40	14	18	515	55	11	265	79		2.9

NY-300/40	LGJ-300/40	40	16	18	535	55	11	265	88		3.1
NY-300/50	LGJ-300/50	40	18	18	560	65	12	265	98	1	3.1
NY-300/70	LGJ-300/70	42	22	20	600	70	12	265	122		3.9
NY-400/20	LGJ-400/20	45	14	18	540	55	13	280	84		3.6
NY-400/25	LGJ-400/25	45	14	18	550	55	13	280	91		3.7
NY-400/35	LGJ-400/35	45	16	20	580	65	13	280	99		4
NY-400/50	LGJ-400/50	45	20	20	590	65	13	280	117		4.2
NY-400/65	LGJ-400/65	48	22	22	620	70	13	280	123		5.4
NY-400/95	LGJ-400/95	48	26	26	670	80	15	280	163		6.6
NY-500/35	LGJ-500/35	52	16	20	620	65	14	245	114	2	5.3
NY-500/45	LGJ-500/45	52	18	20	625	70	14	245	122		5.4
NY-500/65	LGJ-500/65	52	22	22	660	70	15	245	146	2	6.2
NY-630/45	LGJ-630/45	60	18	22	660	70	16	290	141	2	7.7
NY-630/55	LGJ-630/55	60	20	22	660	70	16	290	156	2	7.9
NY-630/80	LGJ-630/80	60	24	26	715	80	17	290	183	2	9.1
NY-800/55	LGJ-800/55	65	20	26	735	80	19	335	182	2	10.5
NY-800/70	LGJ-800/70	65	22	26	740	85	19	335	197	2	10.6
NY-800/100	LGJ-800/100	65	26	30	775	85	19	335	229	2	12.1

Strain Clamps (Hydraulic Compression Type,Anchor Forged)

The clamp body and jumper clamp is aluminum,the other parts are hot-dip galvanized steel.

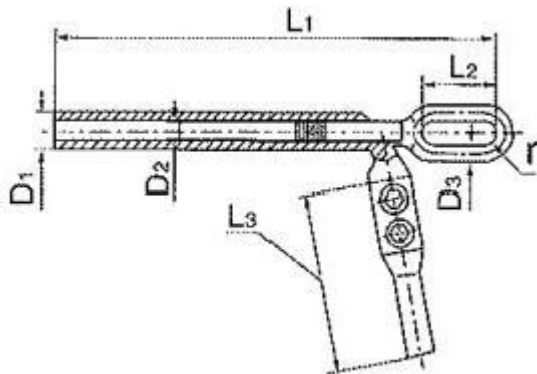

Catalog No	Suitable Conductor	Dimensions (mm)						Slip Strength(kN)	Weight(Kg)
		D	D <sub>2</sub>	D <sub>3</sub>	L <sub>1</sub>	L <sub>2</sub>	L <sub>3</sub>		

NY-240/30.1	LGJ-240/30	36	16	18	490	65	10	240	72	2.9
NY-240/40.1	LGJ-240/40	36	16	18	490	65	10	240	79	3.1
NY-240/55.1	LGJ-240/55	36	20	18	520	65	11	250	97	3.2
NY-300/15.1	LGJ-300/15	40	14	16	481	61	11	265	65	3.6
NY-300/20.1	IGI-300/2C	40	14	18	497	67	11	265	72	3.6
NY-300/25.1	L.GJ-300/25	40	14	18	502	67	11	265	79	3.5
NY-300/40.1	LGJ-300/40	40	16	18	522	67	11	265	88	3.5
NY+300/50.1	LGJ-300/50	40	18	18	542	77	12	265	98	3.9
NY-300/70.1	LGJ-300/70	42	22	20	577	82	12	265	122	4.5
NY-400/20.1	LGJ-400/20	45	14	18	528	68	13	280	84	4.3
NY-400/25.1	LGJ-400/25	45	14	18	538	68	13	280	91	4.3
NY-400/35.1	LGJ...400/35	45	16	20	563	78	13	280	99	4.6
NY-400/50.1	LGJ-400/50	45	20	20	573	78	13	280	117	4.7
NY-400/65.1	LGJ-400/65	48	22	22	598	83	13	280	123	5.4
NY-400/95.1	LGJ-400/95	48	26	26	650	95	15	280	163	7.1

**Aluminium Alloy Strain Clamps (Bolt Type)**

The clamp body and keepers are aluminum alloy, the cotter-pin is stainless steel, the other parts are hot-dip galvanized steel.

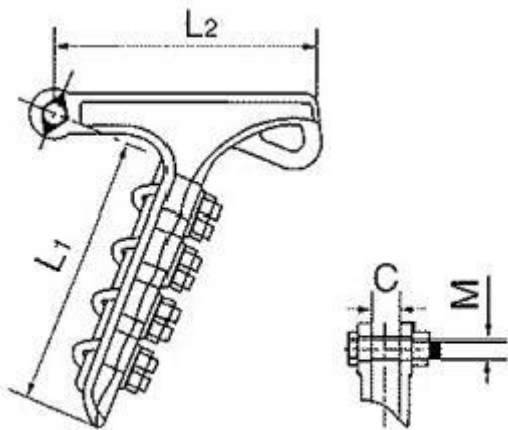

Catalog No.	Conductor Dia (mm)	Dimensions(mm)				U Bolt Qty(pc.)	Rated Failure Load(kN)	Weight(kg)
		M	C	Li	L <sub>2</sub>			
NLL-1	5.1-11.4	16	19	126	108	2	40	0.5
NLL-2	8.9-18.5	16	24	176	187	2	40	1.8
NLL-3	5.0-15.0	16	17.5	190	203	3	70	1.9
NLL-4	12.1-21.8	16	30	298	284	4	90	4.1
NLL-5	18.0-30.0	24	36	446	342	5	620	7

**Strain Clamps for Insulated Cable (Wedge Type)**

The clamp body is aluminum alloy, the clamp core is plastic, the other parts are hot-dip galvanized steel.

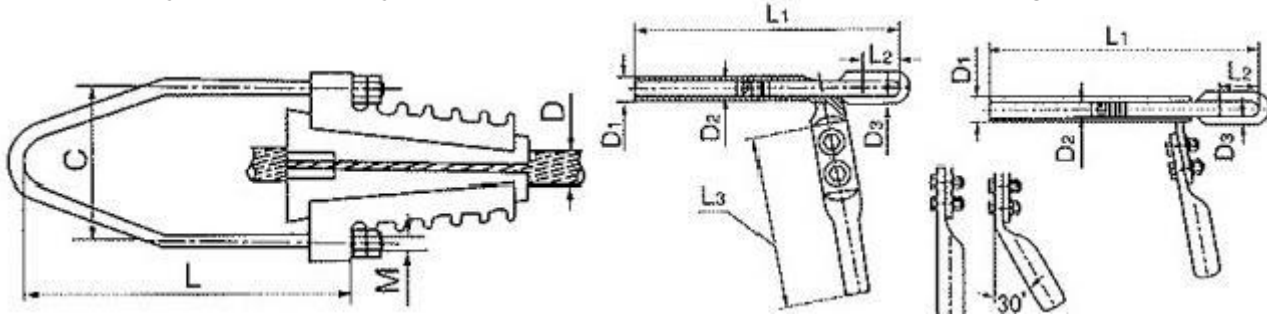

Catalog No.	Suitable Conductor	Dimensions(mm)				Slip Strength(kN)	Weight(Kg)
		C	M	D	L		
NX-I Y	JKLYJ-240	128	12	27	140-240	22.5	2
	JKLYJ-180					17.3	
NX-II Y	JKLYJ-150	128	12	23	140-240	13.6	2
	JKLYJ-120					11.3	
NX-III Y	JKLYJ-95	108	12	20	140-240	8.9	1.6
	JKLYJ-70					6.7	
NX-IV Y	JKLYJ-50	108	12	18	140-220	4.6	1.6
NX-V Y	JKLYJ-35	92	10	12	160-220	3.4	1.1

**Strain Clamps(80 Type)**

The clamp body and jumper clamp are aluminum, the other parts are hot-dip galvanized steel.

Catalog No.	Suitable Conductor	Dimensions(mm)						Slip Strength(kN)	Fig.No.	Weight(Kg)
		D <sub>1</sub>	D <sub>2</sub>	D <sub>3</sub>	Li	L2	L3			
NY-185	LGJ-185	34	18	16	340	50	195	61	1	1.9
NY-185B										
NY-1853	LGJJ-185	34	20	16	370	50	195	67		2.1
NY-185JB										
NY-240Q	LGJQ-240	38	22	16	400	50	225	66		2.4
NY-240QB										
NY-240	LGJQ-240	38	20	16	400	50	225	73	1	2.4
NY-240B										
NY-240J	LGJJ-240	38	22	18	430	50	225	88	1	2.6
NY-240JB										
NY-300Q	LGJQ-300	40	22	16	395	50	265	80	1	2.8
NY-300QB										
NY-300	LGJ-300	40	24	18	445	50	265	104		3.5
NY-300B										
NY-300J	LGJJ-300	40	24	20	465	60	265	116		3.5
NY-300JB										
NY-400Q	LGJQ-400	45	24	18	445	70	280	103	1	3.6
NY-										

400QB										
NY-400	LGJ-400	45	26	20	475	60	280	125		4.1
NY-400B										
NY-400J	LGJJ-400	45	28	22	525	60	280	150		4.6
NY-400JB										
NY-500Q	LGJQ-500	50	30	26	480	70	245	129	2	4.4
NY-600Q	LGJQ-600	55	33	30	S10	75	290	151	2	5.5
NY-700Q	LGJQ-700	60	36	32	575	80	290	180	2	6.3

**Strain Clamps (Explosive Compression Type)**

The clamp body and jumper clamp are aluminum, the other parts are hot-dip galvanized steel.

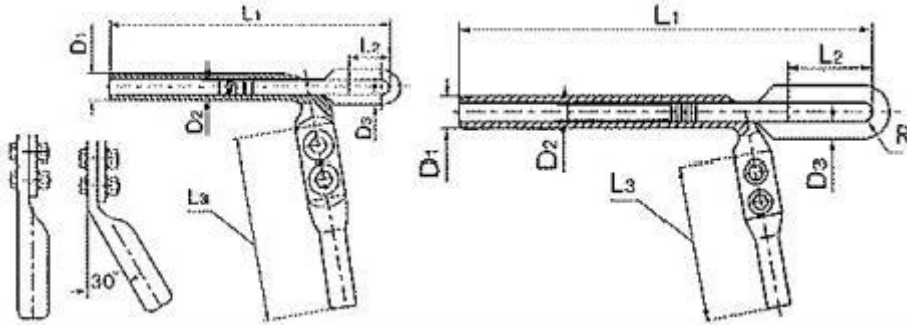

Catalog No.	Suitable Conductor	Dimensions(mm)						Slip Strength(kN)	Weight(Kg)
		D	D <sub>2</sub>	D <sub>3</sub>	L	L <sub>2</sub>	L <sub>3</sub>		
NB-185/30	LGJ-185/30	34	18	16	420	55	255	61	2.4
NB-240/30	LGJ-240/30	36	22	16	415	60	240	42	2.7
NB-300/25	LGJ-300/25	40	22	16	440	60	255	80	2.7
NB-300/40A NB-300/40B	LGJ-300/40	40	22	18	415	55	265	88	3
NB-300/50A NB-300/50B	LGJ-300/50	40	24	18	465	65	265	98	3.2
NB-400/50A NB-400/50B	LGJ-400/50	45	24	20	470	70	280	117	3.8
NB-400/65A NB-400/65B	LGJ-400/65	48	26	20	500	75	280	128	4.2
NB-300/70A NB-300/70B	LGJ-300/70	42	24	20	480	70	265	122	3.5
NB-400/95A NB-400/95B	LGJ-400/95	48	28	22	535	80	280	163	5.1

**Strain Clamps for ACSR/AS Conductor (Hydraulic Compression Type)**

The clamp body and jumper clamp are aluminum, the other parts are hot-dip galvanized steel.

Catalog No.	Suitable Conductor	Dimensions(mm)							Slip Strength (kN)	Weight(Kg)
		D	D <sub>2</sub>	D <sub>3</sub>			L <sub>3</sub>	R		
NY-70/40BG	ACSR/AS-70/40	34	16	16	480	50	180	8.5	57.8	0.4
NY-80/47BG	ACSR/AS-80/47	36	18	16	485	70	230	10	64.6	2.6



NY-95/55BG	ACSR/AS-95/55	36	20	18	486	61	230	11	74	2.9
NY-185/30BG	ACSR/AS-185/30	36	16	16	550	55	220	9	62.9	2.9
NY-240/40BG	ACSR/AS-240/40	38	18	18	595	65	240	12	81.6	3.3
NY-300/25BG	ACSR/AS-300/25	42	14	18	560	55	265	11	74.4	3.6
NY-300/40BG	ACSR/AS-300/40	42	18	18	615	70	265	13	90	3.8
NY-300/50BG	ACSR/AS-300/50	42	18	18	620	70	265	13	101.0	4.1
NY-300/70BG	ACSR/AS-300/70	42	22	20	640	70	260	13	117.8	4.4
NY-400/35BG	ACSR/AS-400/35	48	18	20	635	65	280	13	99	5.2
NY-400/50BG	ACSR/AS-400/50	48	20	20	645	65	280	13	117	5.2

**Strain Clamps for AS.Stranded Wire (Hydraulic Compression Type)**

The clamp body 、 lining sleeve and jumper clamp are aluminum.The other parts are hot...dip galvanized steel.

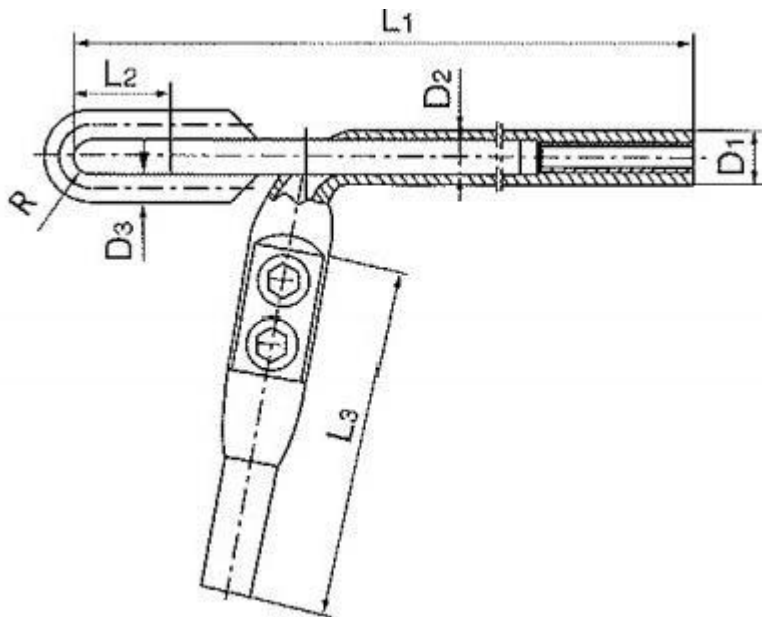

Catalog No.	Suitable Conductor	Dimensions(mm)							Slip Sirength (kN)	Weight(Kg)
		D	D <sub>2</sub>	D <sub>3</sub>			L <sub>3</sub>	R		
NY-50BG	LB20J-50	32	18	16	275	64	195	9	55.8	1.7
NY-70BG	LB27J-70	32	20	16	380	50	185	10	65.8	1.7
NY-80BC	LB20J-80	36	24	18	417	67	185	12	85	2.5
NY-95BG	LB40J-95	34	24	16	400	60	200	10	56	2.5
NY-120BG	LB27J-120	36	26	20	375	70	210	13	112	3
NY-150BG	LB40J-150	42	26	20	530	75	265	13	86	3.8
NY-150.1BG	LB20J-150	45	32	30	560	90	280	16	167	7.3
NY-240BG	11B27J-240	50	36	30	620	110	280	18	221.3	7.8

**Strain Clamps for Heat-Resistant Aluminium Alloy Stranded Conductor (Hydraulic Compression Type)**

The clamp body and jumper clamp are aluminum, the other parts are hot-dip galvanized steel.

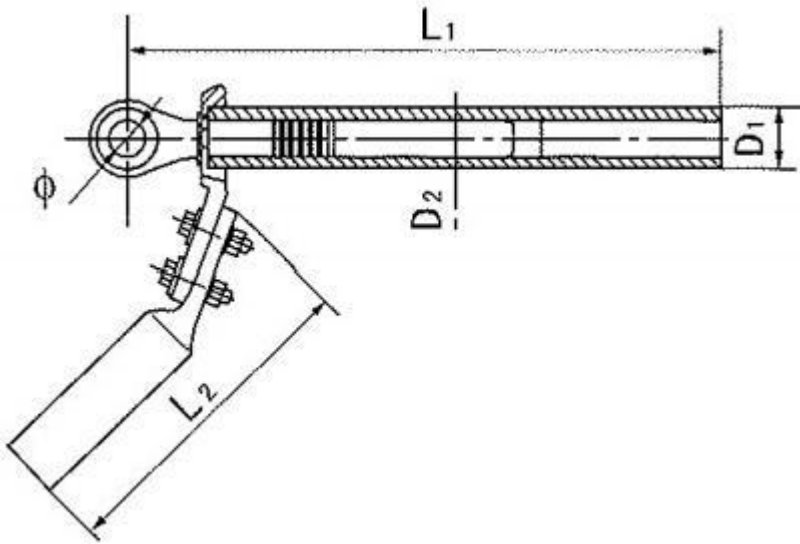

Catalog No.	Suitable Conductor	Dimensions(mm)							Slip Sirength (kN)	Weight(Kg)
		D	D <sub>2</sub>	D <sub>3</sub>			L <sub>3</sub>	R		
NY-50BG	LB20J-50	32	18	16	275	64	195	9	55.8	1.7
NY-70BG	LB27J-70	32	20	16	380	50	185	10	65.8	1.7
NY-80BC	LB20J-80	36	24	18	417	67	185	12	85	2.5
NY-95BG	LB40J-95	34	24	16	400	60	200	10	56	2.5
NY-120BG	LB27J-120	36	26	20	375	70	210	13	112	3
NY-150BG	LB40J-150	42	26	20	530	75	265	13	86	3.8
NY-150.1BG	LB20J-150	45	32	30	560	90	280	16	167	7.3
NY-240BG	11B27J-240	50	36	30	620	110	280	18	221.3	7.8

The Clamp body and jumper clamp are aluminum, the other parts are hot-dip galvanized steel.

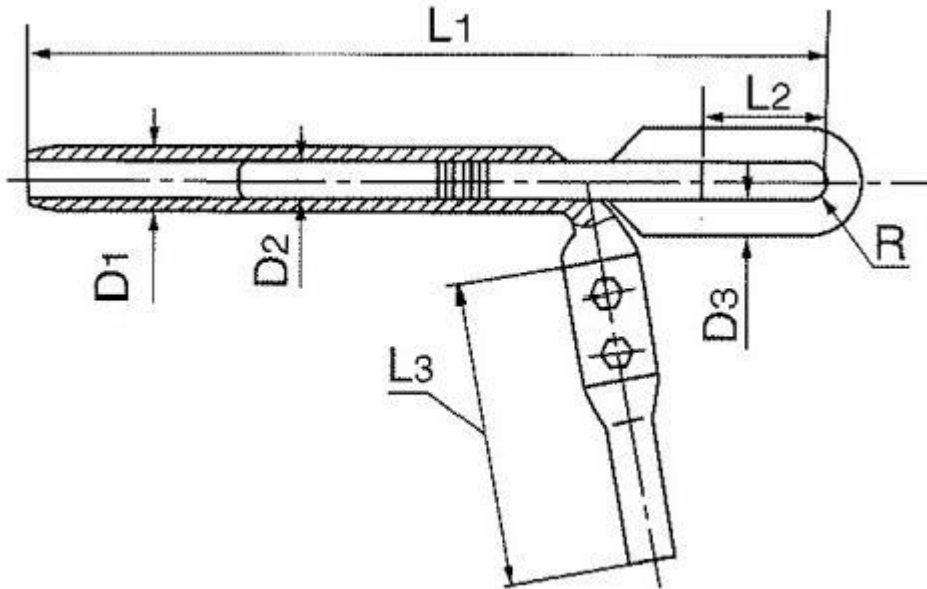

Catalog No.	Suitable Conductor	Dimensions(mm)							Slip Sirength (kN)	Weight(Kg)
		D	D <sub>2</sub>	D <sub>3</sub>			L <sub>3</sub>	R		
		Di	D2	ID3	R	L1	L.2	L3		
NY-185/30N	NRLH8GJ-185/30	36	16	16	10	545	55	265	63	4.2
NY-240/30N	NRLH8GJ-240/30	45	18	18	10	545	55	285	68	4.4
NY-400/50N	NRLHSGJ-400/50	55	20	20	13.5	605	65	315	102	7.6



**Strain Clamps for AACSR(Hydraulic Compression Type)**

The clamp body and jumper clamp are aluminum, the other parts are hot-dip galvanized steel.

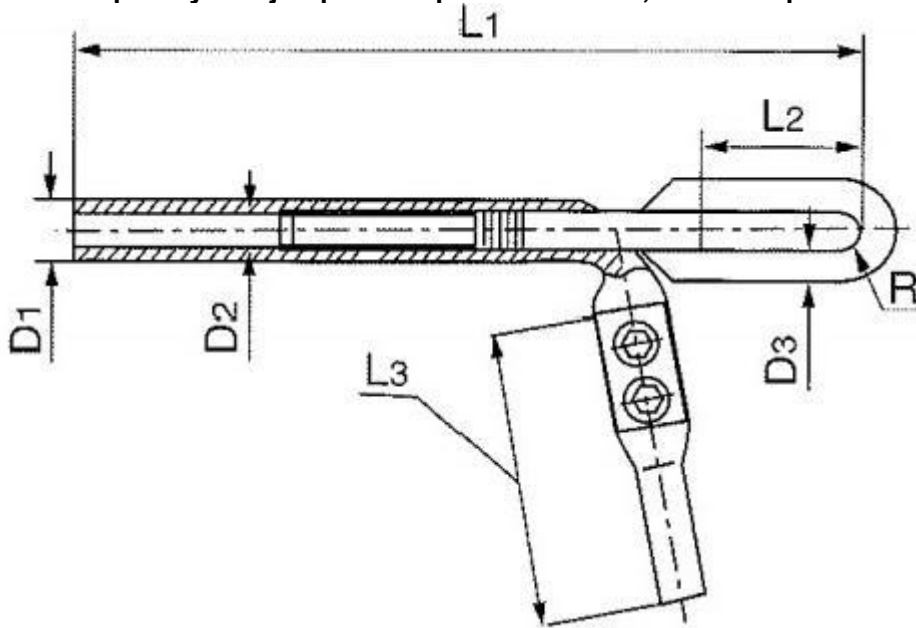

Catalog No.	Suitable Conductor	Dimensions(mm)							Slip Strength(kN)	Weight (Kg)
		D1	D2	D3	R	L1	L2	L3		
NY-120/25N	AACSR-120/25	36	14	16	10	480	60	280	61	3.2
NY-185/45HG2	AACSR-185/45	42	18	20	11.5	505	70	265	96	3.5
NY-240/40HG1	LHgGJ-240/40	45	16	20	12	750	70	280	109	4.5
NY-240/55113	LH <sub>4</sub> GJT-240/55	45	20	22	13	740	70	280	126	5.2
NY-300/70H	LH <sub>4</sub> GJT-300/70	50	22	22	16	745	116	265	160	6.5
NY-400/95HT	LHsGJ-400/95	55	26	30	22	850	125	280	215	10